



## 52 Claremont Place Table Top NSW

4 2 6

A truly rare find, 'Windale' 52 Claremont Place is a unique property tucked away at the end of a treelined driveway on a 3.46 Ha (approx.) allotment, in a desirable, highly sought-after address. This stunning property delivers plenty of space to enjoy with family and friends. With plenty of natural light, this family home features an open plan layout with 4 bedrooms, 3 separate living areas, a study and an exceptional enclosed entertaining space with a cosy wood fire, 6 car accommodation and a 16m x 7.5m (approx.) shed.

A wonderfully accommodating home with picturesque outlooks, this property is the perfect place to enjoy the peaceful and private surrounds being that of Tabletop Mountain and Lake Hume also being nearby, whilst still being nestled in amongst other quality established homes.

**Price** : \$ 1,280,000  
**Land Size** : 3.46 ha  
**View** : <https://www.kanerealestate.com.au/sale/nsw/murray-region/table-top/residential/acreages/mirural/6654403>



**Cameron Brooks**  
0260400224



**Andrew Kane**  
0260400224

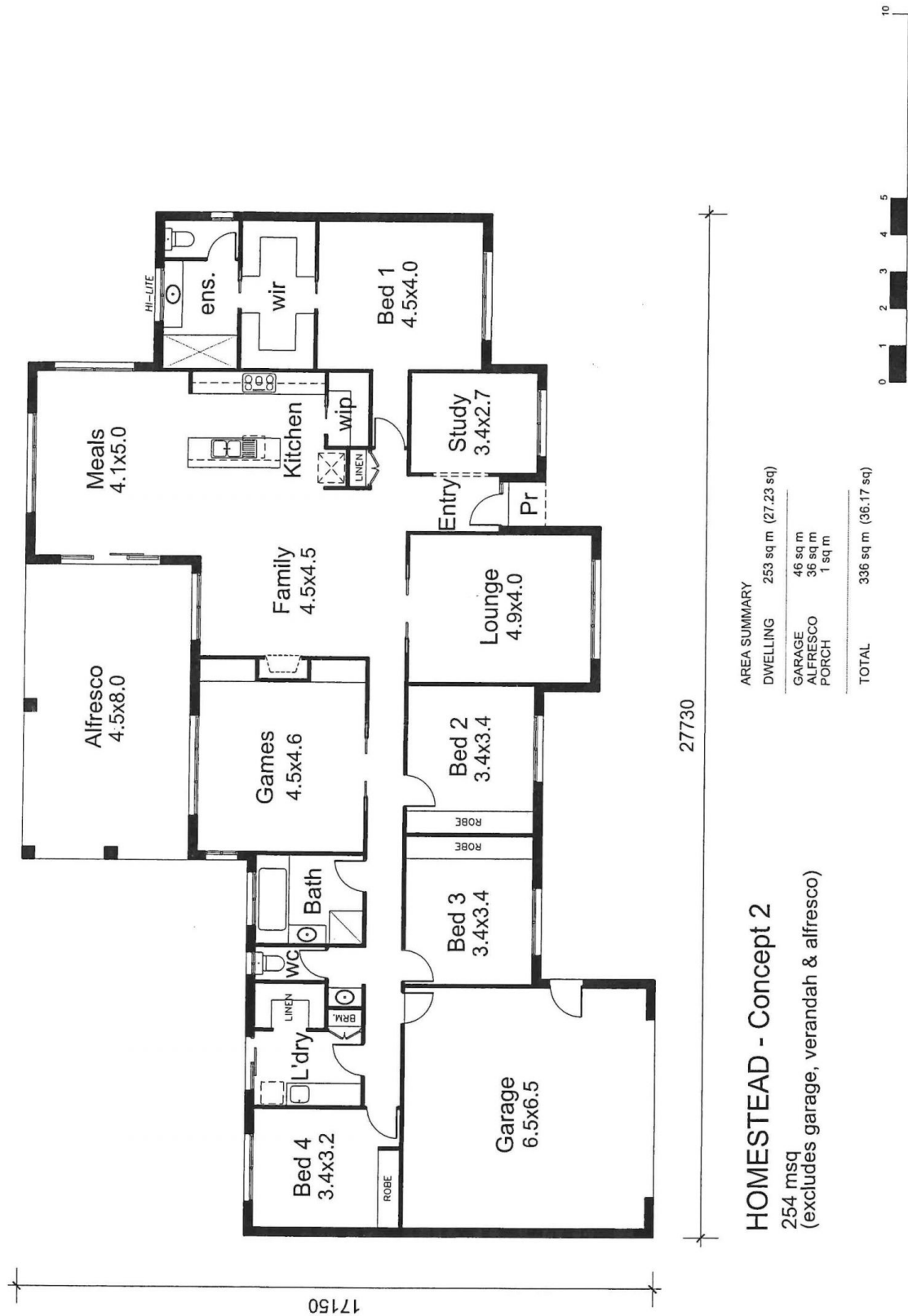

**HOMESTEAD - Concept 2**  
254 msq  
(excludes garage, verandah & alfresco)

AREA SUMMARY	
DWELLING	253 sq m (27.23 sq)
GARAGE	46 sq m
ALFRESCO	36 sq m
PORCH	1 sq m
TOTAL	336 sq m (36.17 sq)

CLIENT:	SCALE:	SHEET No.	REVISION:
	DATE:	A2	
	DRAWN BY:		

© Copyright - All Rights Reserved